



Salt River Pima-Maricopa Indian Community

Public Works Department

CONSTRUCTION NOTICE

CLASSROOM RENOVATIONS

GROUP #4

- Where:** Early Childhood Education Center (ECEC)
All Classrooms & Building C South Side Infant Playground Area
- When:** July 24, 2023 – **May 1, 2024**
Group #4 December 21, 2023 – February 6, 2024
- Scope of Work:** The Classrooms scope of work includes but is not limited to classroom painting, ceiling tile, lighting and HVAC heat pump and restroom door replacement. Infant Playground includes new playground surface, fencing and layout.
- Reason for Work:** Classroom & Parking Expansion and Minor Facility Renovations
- Anticipated Disruption:**
- (4) Classrooms will be closed and under renovation at a time. No access to these classrooms will be allowed while renovations are in progress. Anticipated duration is 3-4 weeks for each group of (4) rooms. Contactor will be responsible for packing and relocating classroom prior to the start of the next (4) rooms. **Group #4 rooms A-138, A-121, B-143, C-109.**
 - Building C South Side Infant Playground area will be under construction.
 - Noise and vibration disruptions may occur during construction activities.
 - Playground and site access may be reduced at times to accommodate work. Specific restrictions will be noted in advance.
 - Construction personnel will be active in portions of the site and building. Anticipated work hours are 5:00 am – 2:00 pm. M-F

Dates and durations noted are subject to change based on construction progress and / or unforeseen conditions.

Public Works and the Contractor will endeavor to minimize disruptions due to this work as much as possible.

For questions or concerns regarding this notice contact SRPMIC Public Works, Sr. Project Manager, Dwayne Wilson at 480-362-2666 or Dwayne.Wilson@SRPMIC-nsn.gov .



Salt River Pima-Maricopa Indian Community

Public Works Department

CLASSROOM SEQUENCE

GROUP #1 - (A-146, A-147, B-149, B-157) | Complete

GROUP #2 - (A-154, A-139, B-135, C-102) | Complete

GROUP #3 - (A-131, A-120, B-142, C-108) | Complete

GROUP #4 - (A-138, A-121, B-143, C-109) | 12/21/23 - 2/6/23

GROUP #5 - (A-128, B-150, C-122, C-115) |

GROUP #6 - (A-113, C-116) |

BUILDING B ADDITION PHASE 1

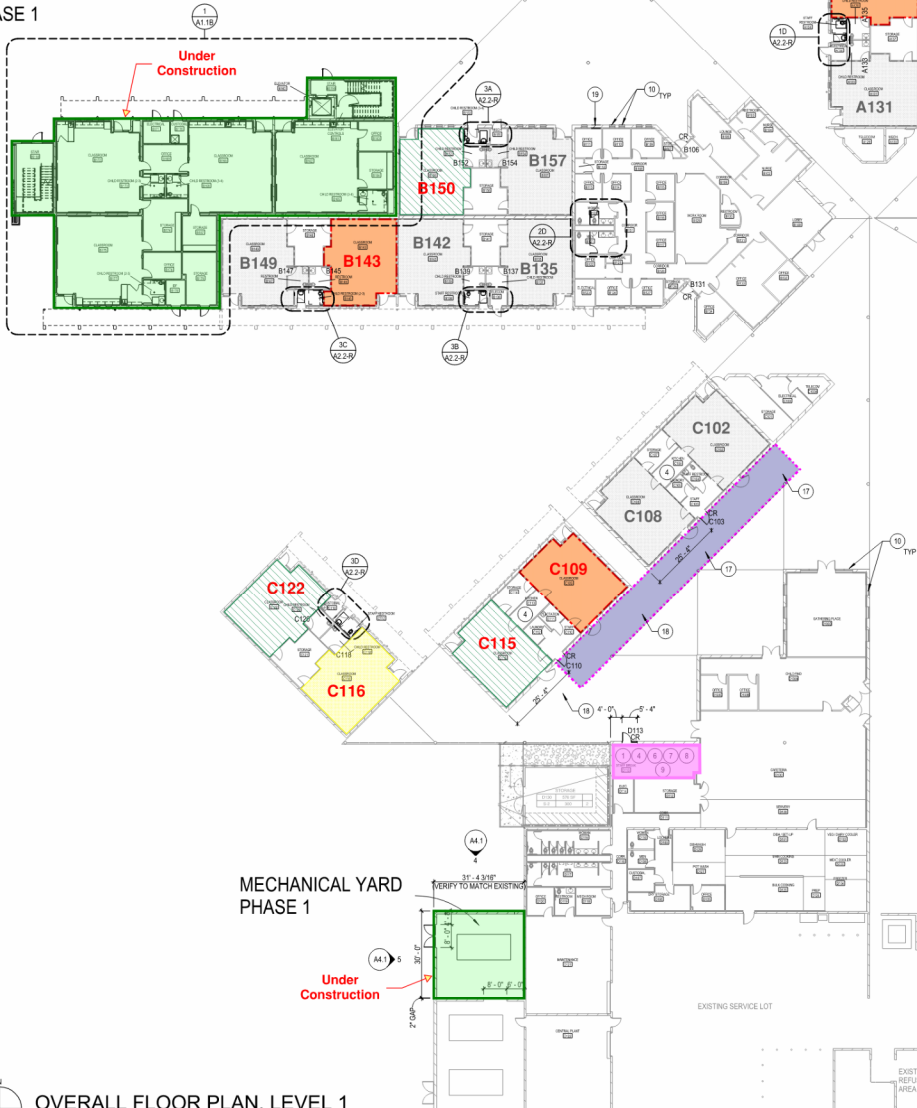

BUILDING A ADDITION PHASE 2

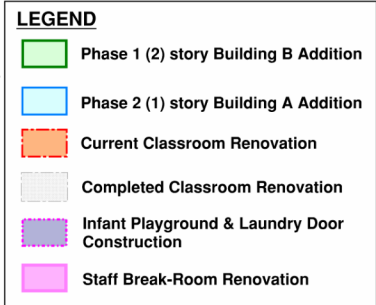

OVERALL FLOOR PLAN, LEVEL 1
SCALE: 1" = 20'-0"